

Rev2 Design Review



B. Sun

SGI

3/9/2000

RV Spring/CLD Material

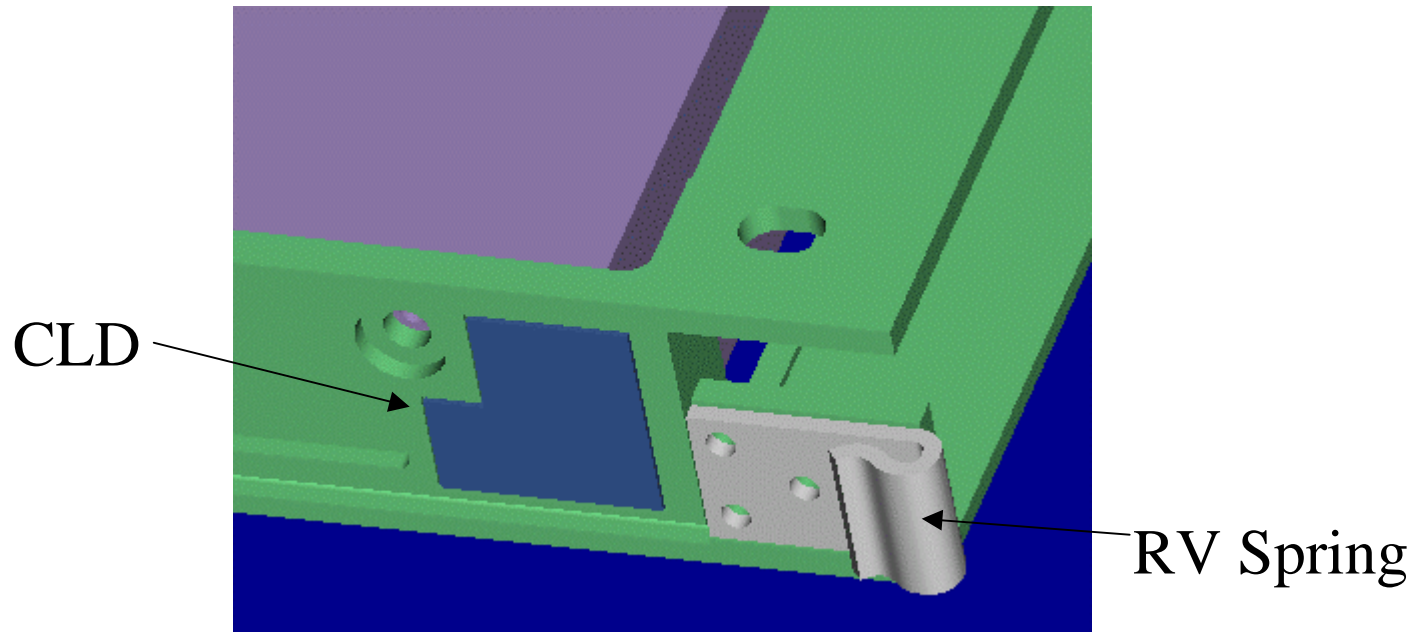

- Spring rigidly attaches wrapper to sheet metal
- Spring does not deflect/bow sheetmetal
- Reduction of vibration transmission path

RV Spring/CLD Material



- CLD pinched between wrapper and sheetmetal
- CLD (Constrained Layer Damper) bottoms out under the force of the RV clip
- Spring force tuned/optimized from rev1 analysis

Sheet Metal Design



- Majority stiffness designed into bottom sheetmetal
- Overall stiffer dock design
- Optimized stiffener added to center section

Preliminary alternative concept

Lower profile handle

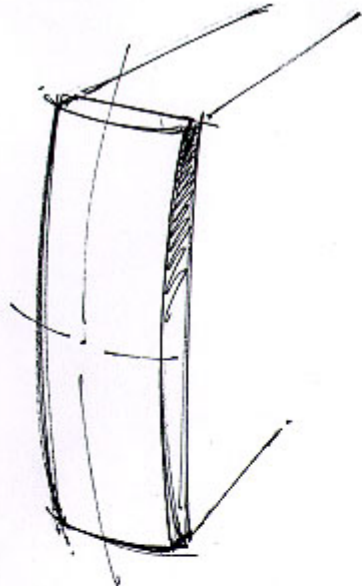

• EXPLORE FORM VARIATIONS

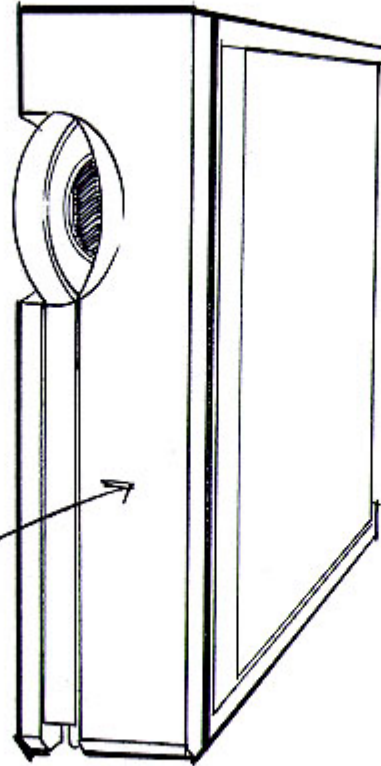

• LIBERAL VENTING REQUIRED ON BEZEL & HANDLE

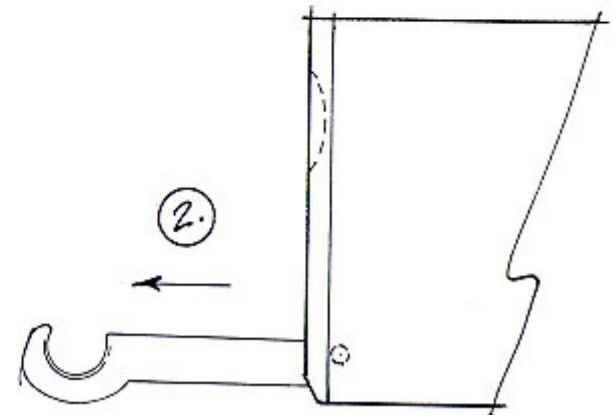
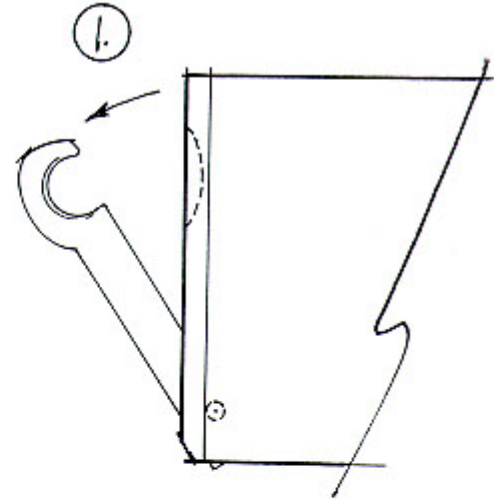

Guide Rails

- Guide rails bent near connector end
- Stiff enough to stabilize connector
- Compliant enough- does not preload connector

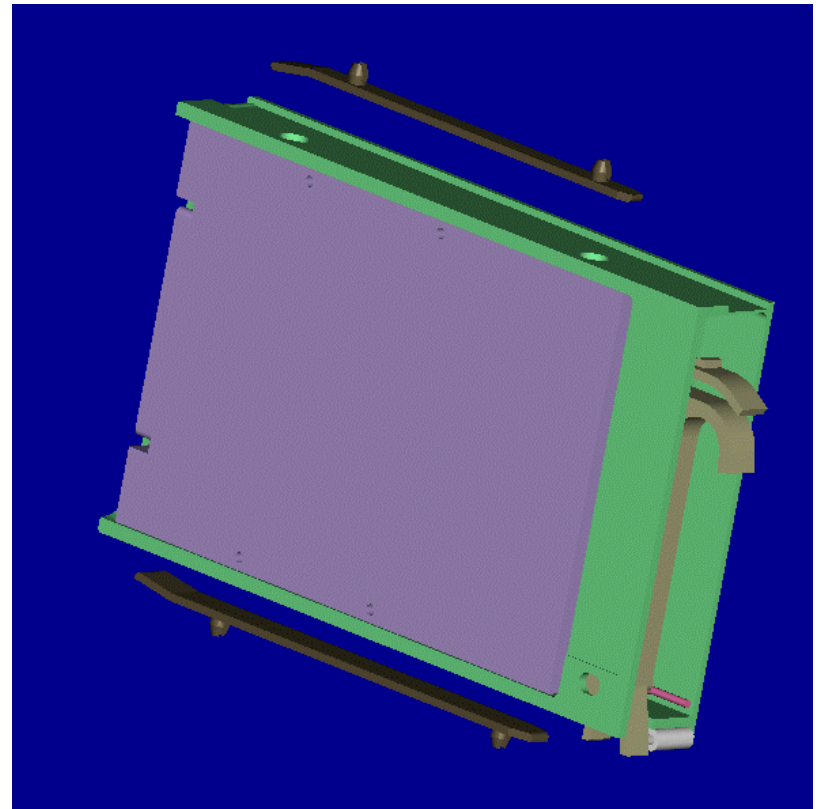

Guide Rails

- Guide rail leaf spring reaction helps support connector end, stabilizes/damps motion

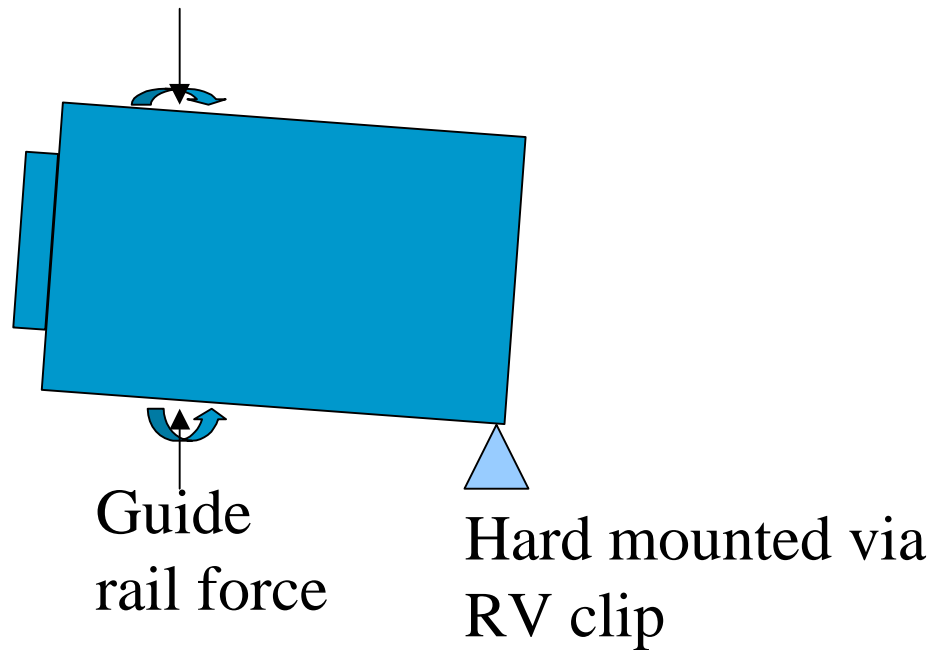

Light Pipe

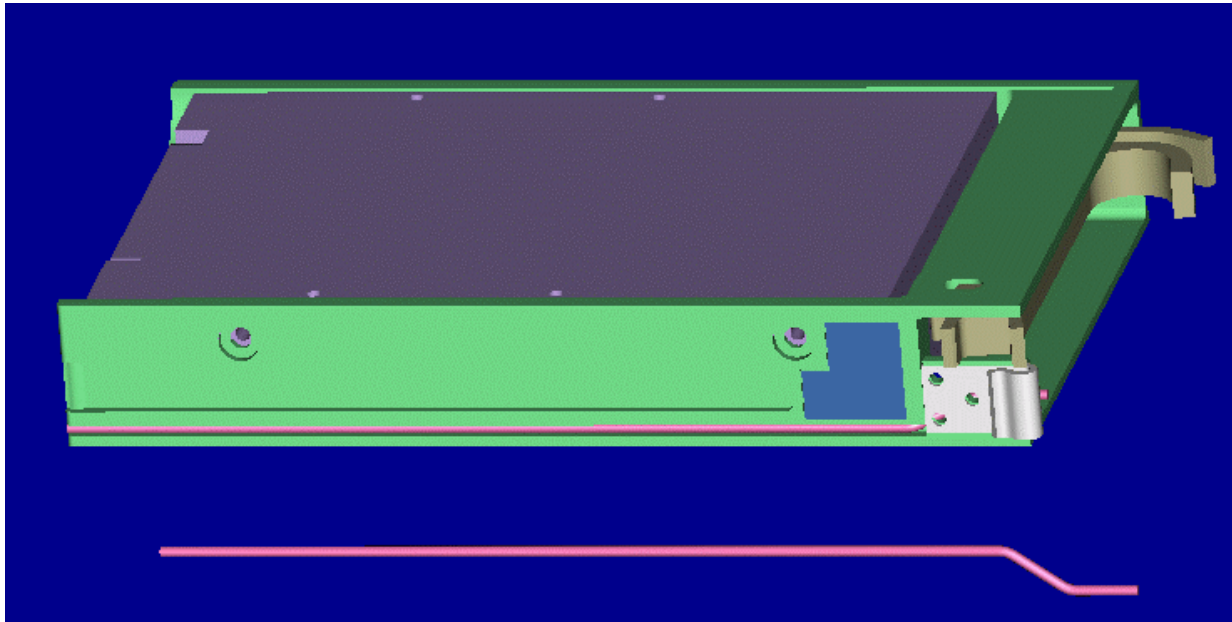

- Kingston Technologies
- Single acrylic light pipe
- snaps into detail of wrapper casting
- < .1 in diameter, <45 deg bends

B. Sun, SGI



Backplane LEDs

- Surface mount bi-colored LEDs
- Indicators:
 - power
 - activity
 - fault

EMI Gasket

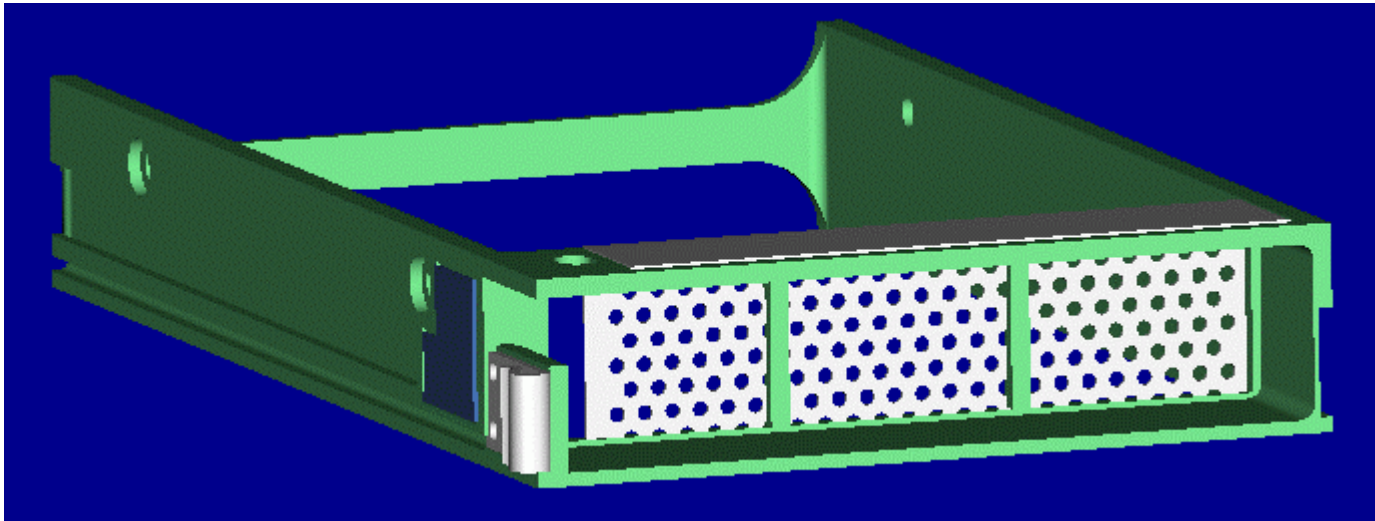

- Upgradeable EMI gasket
- Separate single sheet metal unit
- Held captive using plastic bezel